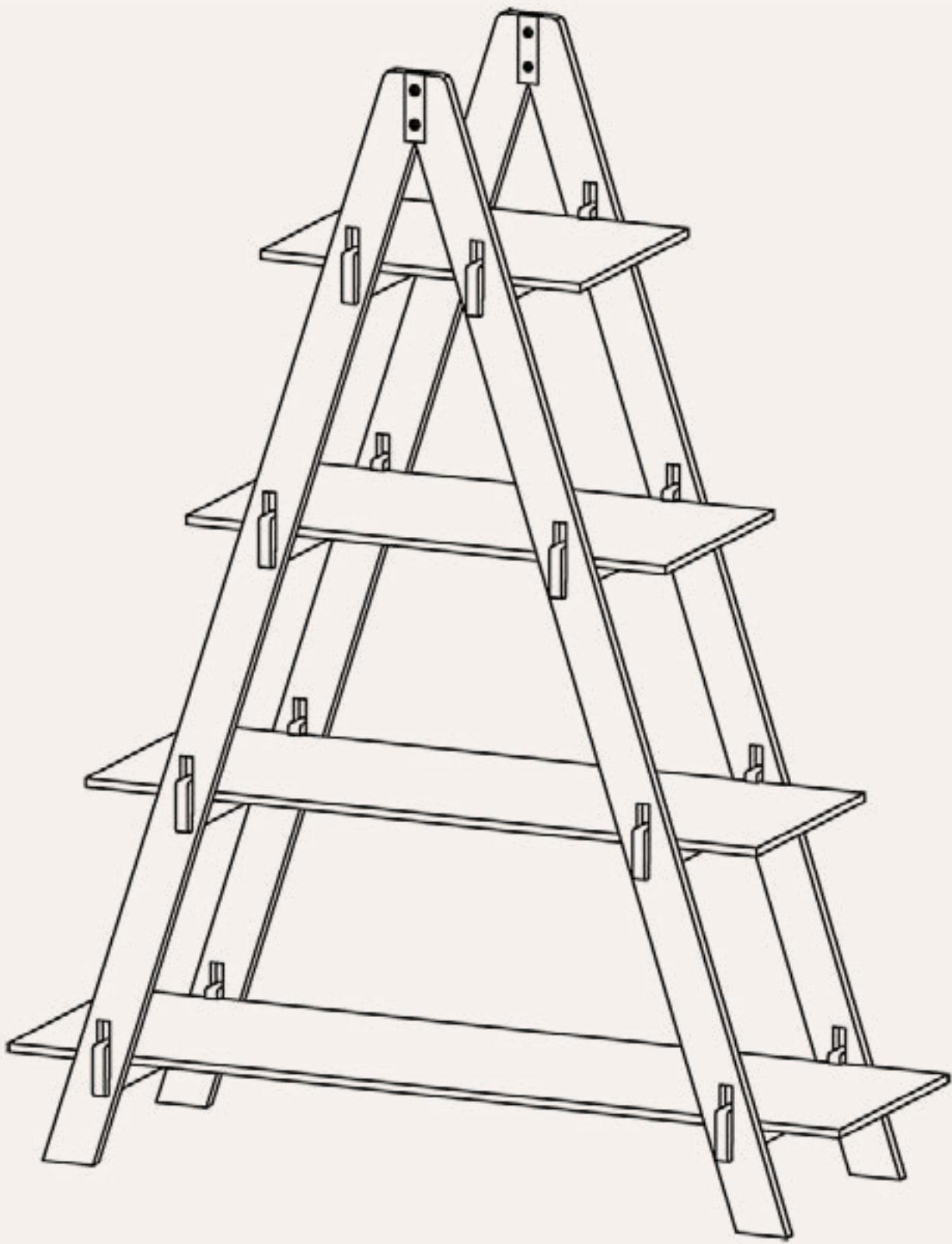


FLOURISH COLLECTION



SKU: DBAFSH1

A-Frame Shelving Unit **USER GUIDE**

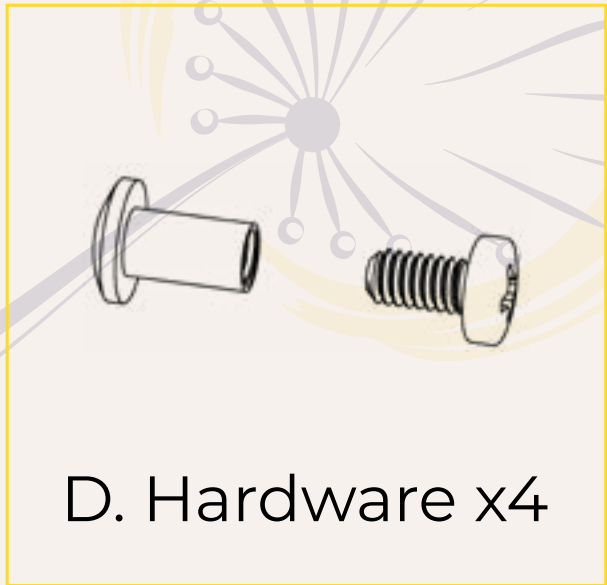
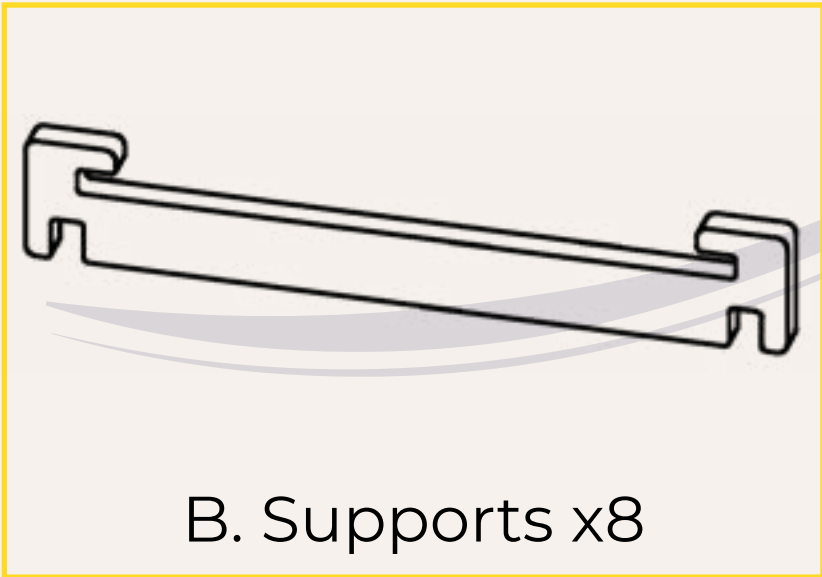
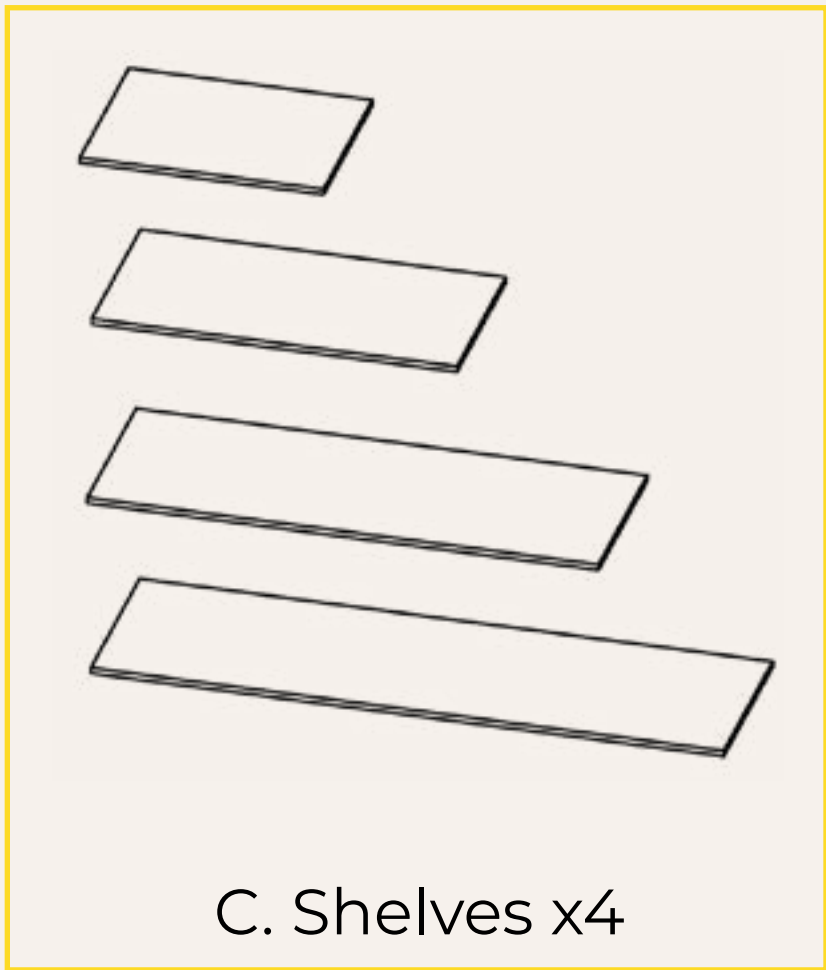
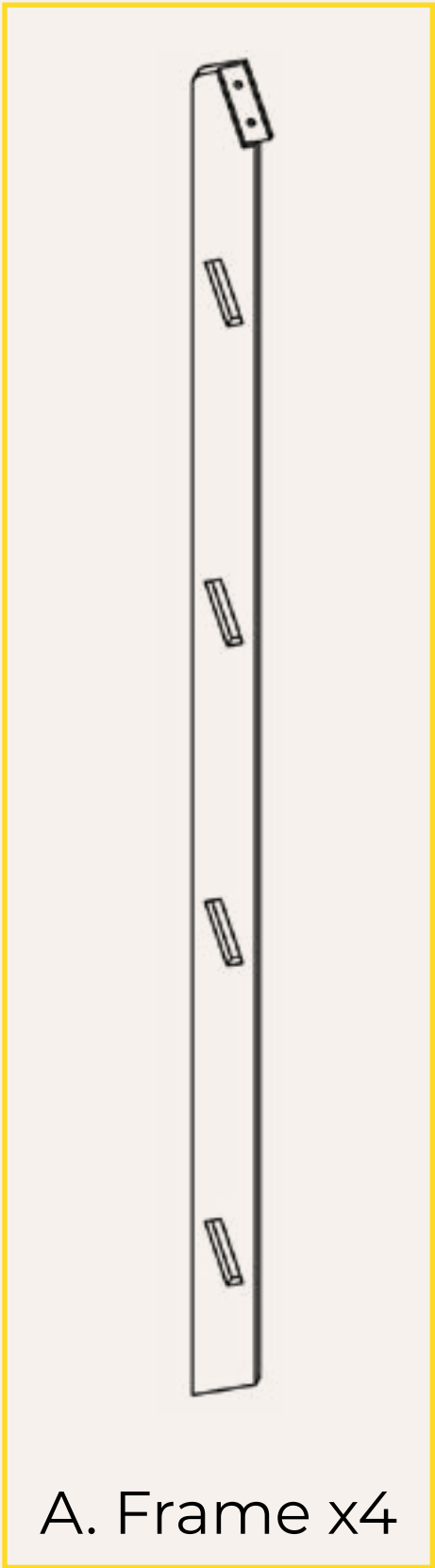
DANDELION

RESPONSIBLY CREATING BETTER PRODUCTS FOR A BETTER WORLD

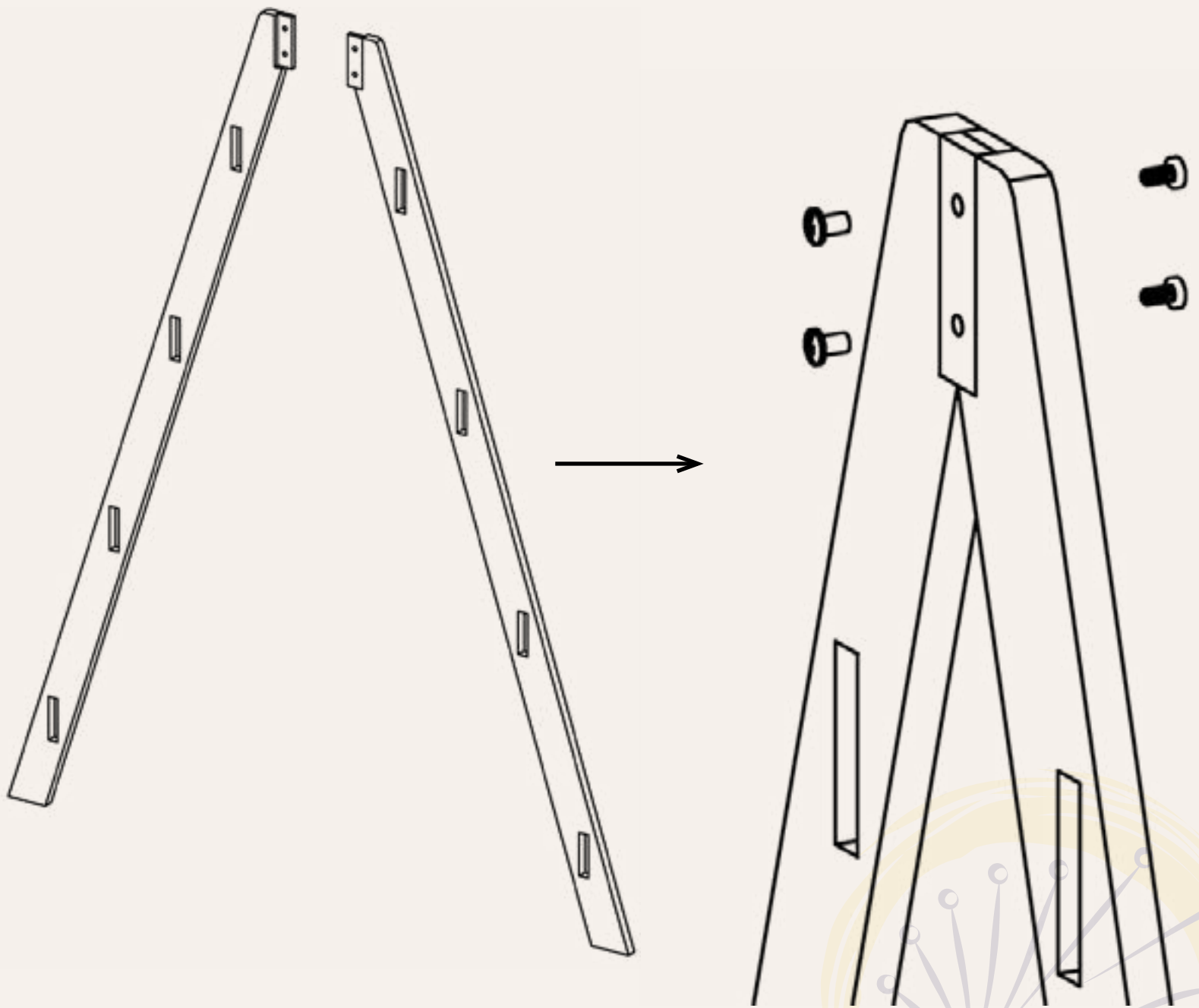


Table of Contents

USER GUIDE

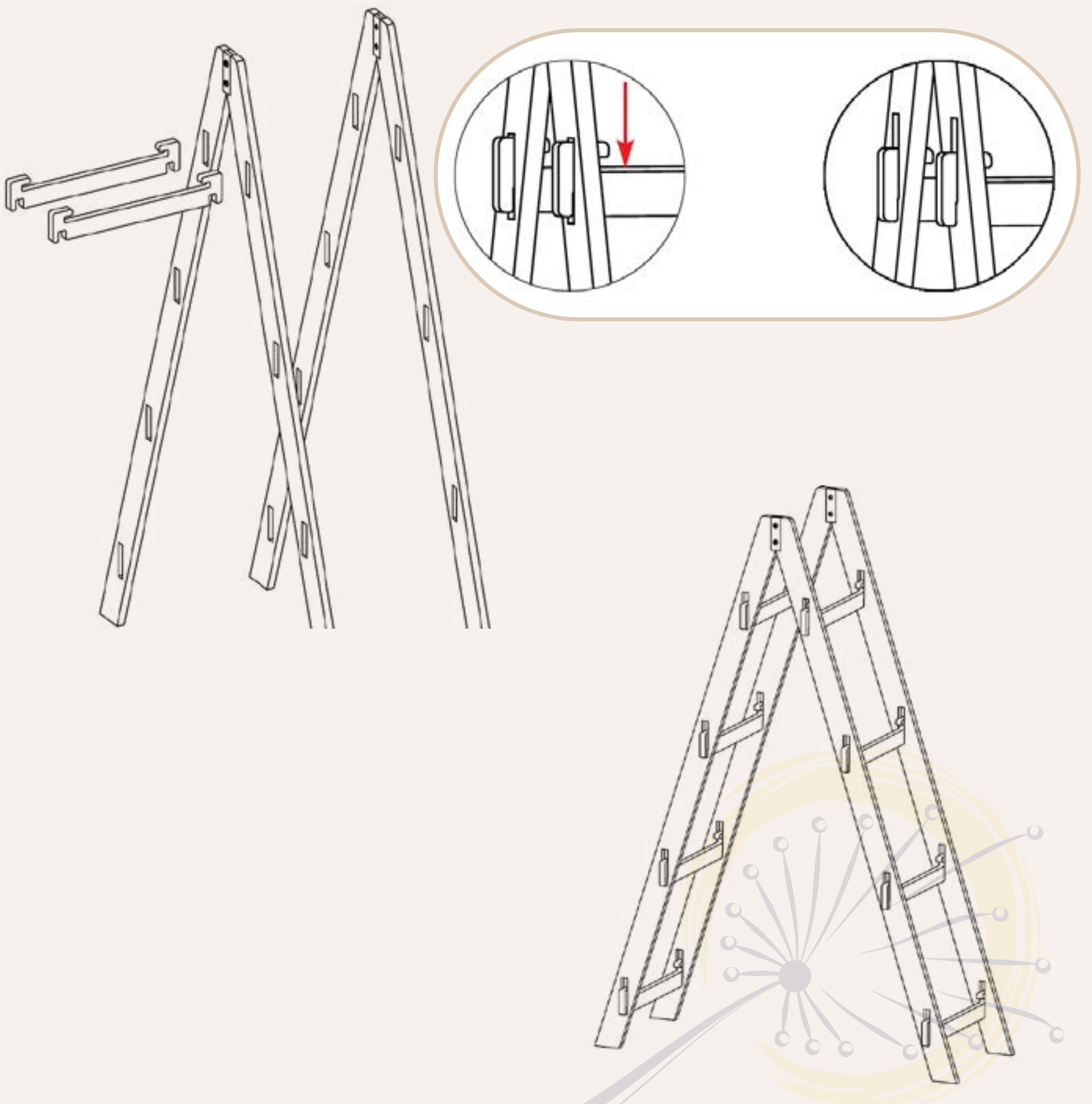


PARTS DIAGRAM



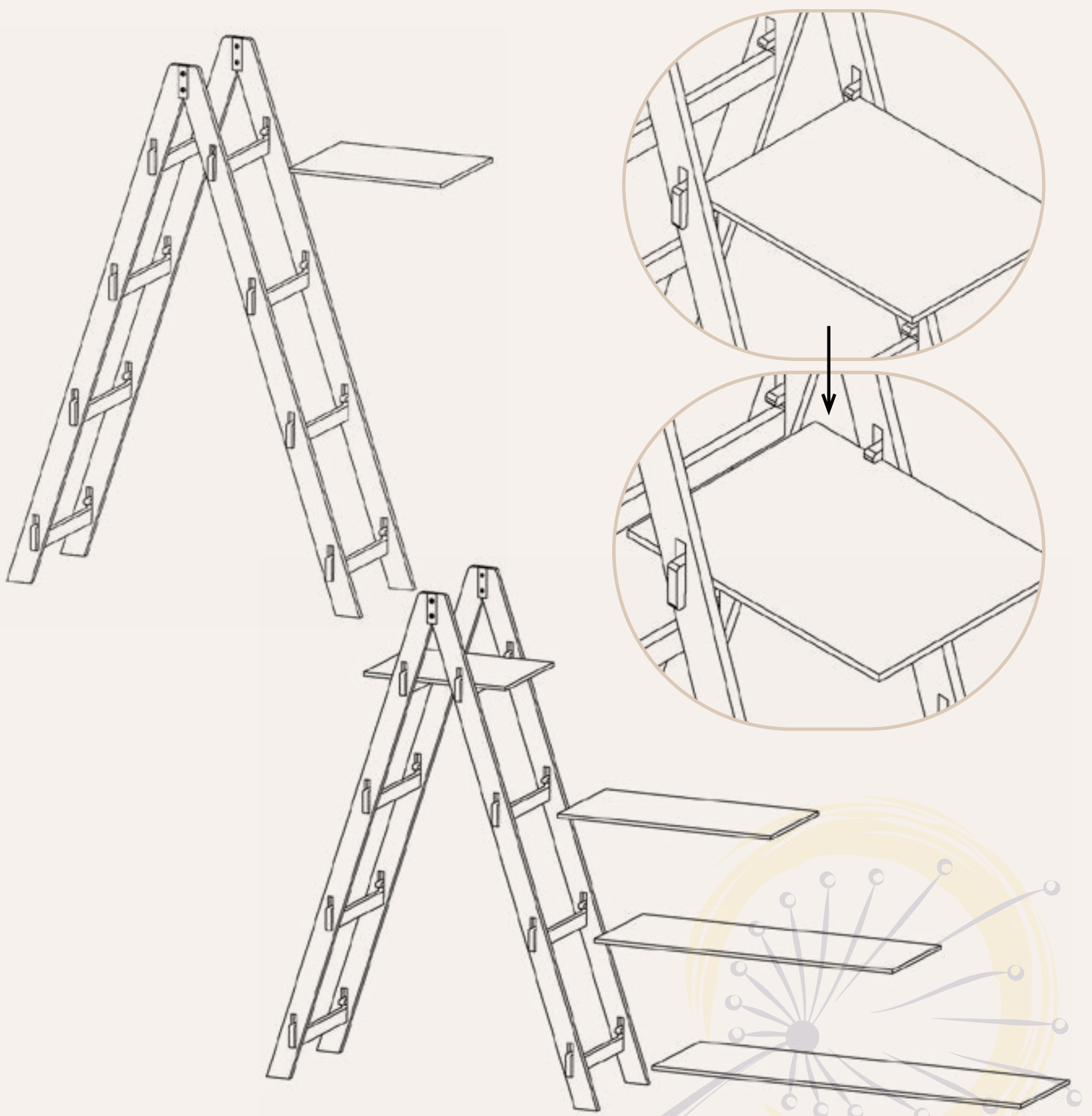
1. Align frame pieces so that they form the A-frame shape of the unit, as shown. The tops of these pieces should slot together with peg holes lined up.
2. Insert pegs from either side to lock frame into place.
3. Repeat for second set of frame pieces.

ASSEMBLY INSTRUCTIONS



4. Slide **all** slats for A-frame piece into place, then press them down to secure them.
5. Press-fit second side of the frame onto the slats to form the unit, as shown.

ASSEMBLY INSTRUCTIONS



7. Slide shelves into the unit, resting on the supports. The shelves will be fitted through the slots of the supports.

8. Once all shelves are inserted, assembly is complete.

ASSEMBLY INSTRUCTIONS

THANK YOU FOR SPREADING
THE SEEDS OF SUSTAINABILITY
AND HELPING TO PROTECT
OUR PLANET.



HAVE A QUESTION? GET IN TOUCH WITH
OUR DANDELION REPRESENTATIVES AT:
888-257-6639

CONTACT US